

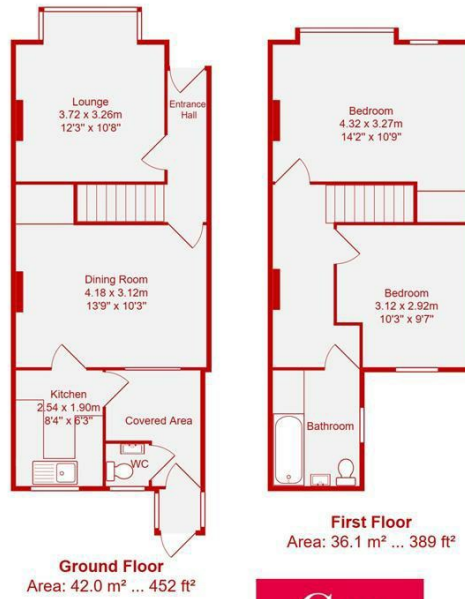

- **Period Terraced House**
- **The Property Requires Modernisation**
- **South Facing Rear Garden**
- **Popular Location**
- **Separate Lounge & Dining Room**
- **Two Double Bedrooms**
- **Fantastic Opportunity To Improve and Extend (stp)**
- **No Onward Chain Vacant Possession**
- **Only 0.6 Miles From Portslade Mainline Railway Station**
- **Downstairs WC**

Eastbrook Road, Portslade

Price: £325,000 Freehold



Total Area: 78.1 m² ... 841 ft²

All measurements are approximate and for display purposes only.

Positioned in a highly convenient part of Portslade, Eastbrook Road offers an ideal blend of connectivity and everyday lifestyle. Just a short walk away, Portslade railway station provides mainline services with direct access to both Brighton and London, making it a superb choice for commuters.

Also within easy reach is the ever-popular Boundary Road shopping district, known for its vibrant mix of independent shops, cafés, bars, and restaurants. Whether it's grabbing a morning coffee, dining out, or picking up essentials, everything you need is right on your doorstep.

This location combines excellent transport links with a strong sense of community, making it particularly appealing to buyers looking for both convenience and lifestyle.

